

## Quick Install Guide

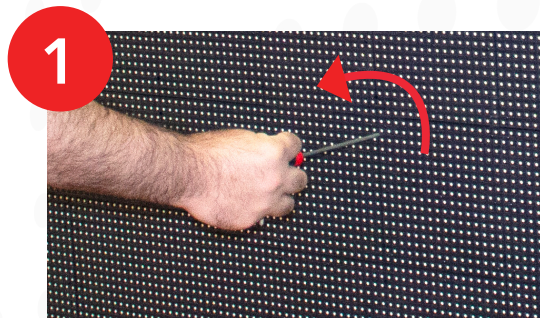

**Master Cabinet (bottom right corner)**

Open bottom right cabinet of the master & slave sign using the T-handle allen wrench in the accessories box to unfasten the bolts set-back in the sign.

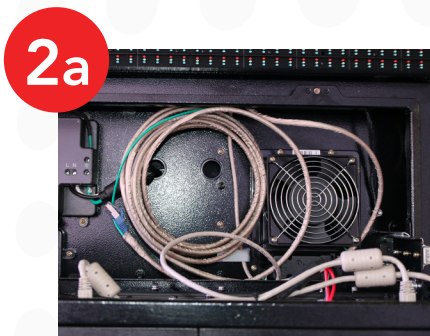

**Cat 5 in Slave**

Connect Cat 5 (found in lowest right cabinet of **slave sign**) from Slave to the Master's controller. Cat 5 should connect to port #2 unless it is specified differently.

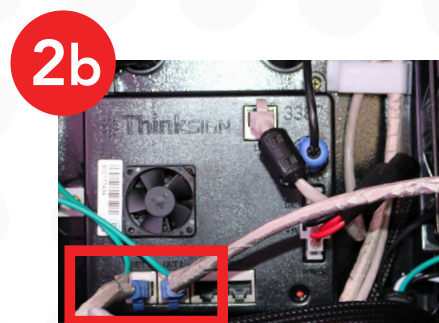

**Main Controller in Master**

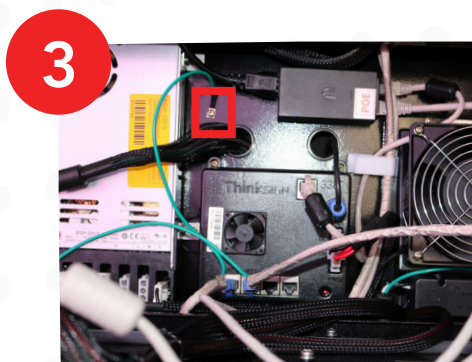

Make sure the ground cables are connected to the body of the unit to avoid electrical damage.

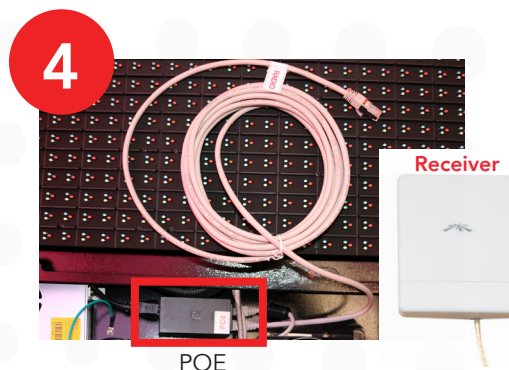

Connect Cat 5 in Master's POE to the Receiver.



Connect Temp/Brightness Sensor (Found in accessories box) to the back of the Master side sign.

**Flip Over For Next Steps**



## Quick Install Guide

6



Install receiver in upright position with good line of sight to sender. Receiver must be installed outside of the monument.

7

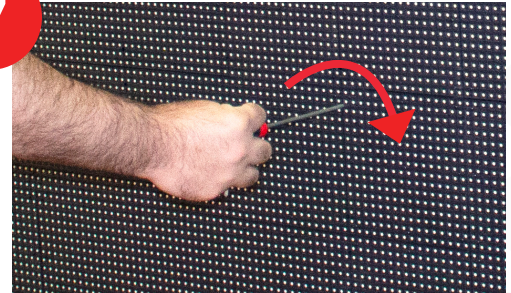

**Master Cabinet (bottom right corner)**

After all the cables are connected and the receiver is setup, fasten the bolts set-back in the sign using the same T-handle allen wrench used to unfasten them.

8

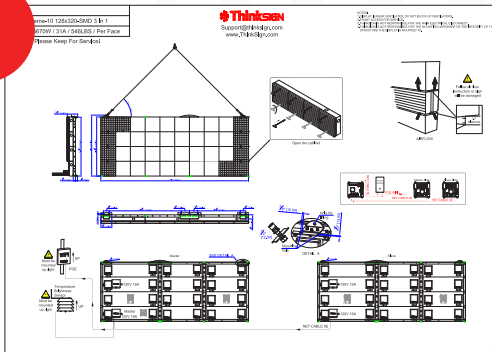

Using the shop drawing ensure that the sign is receiving the required voltage, amperage and it's own dedicated circuit. Requirements stated per face, double requirements if it master & slave.

9



Locate on the master cabinet's right side the ThinkSIGN sticker with the Serial # and Model # info required for Tech Support to help with the network configuration.

**Continue with installation using  
Network Configuration Quick Start Guide**